





LA RIVER STUDIOS



NOW AVAILABLE FOR SHORT AND LONG-TERM FILMING ENGAGEMENTS!

LA River Studios, in the heart of North East Los Angeles, offers content makers a versatile warehouse space equipped with 22-foot ceilings, 5 skylights, exposed brick walls and an original fire door for an authentic warehouse aesthetic. The space is perfect for a wide range of commercials, films, TV shows and still photoshoots.

This historic 1930's toy truck factory has character and versatility. The 15,000 s.f. filming location is conveniently situated between Downtown Los Angeles and Silverlake.

- 
- Exposed brick
 - Original bow-truss ceilings
 - Original fire door
 - New, Well Appointed Restrooms (5+)
 - Green Rooms & Production Offices
 - HVAC
 - Power - (2) 200-amp 3-phase company switches, ample 20-amp circuits
 - High-speed dedicated Fiber Internet with redundant connection
 - Multiple access points and loading dock
 - Comprehensive COVID safety plan



Located within 1-2 miles of the Studio

- FedEx
- Smart and Final
- Home Depot
- Harbor Freight
- Super A Foods
- Liquor + Gas Station

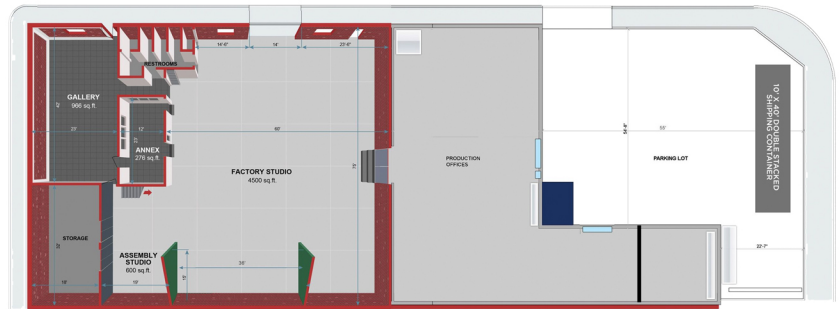
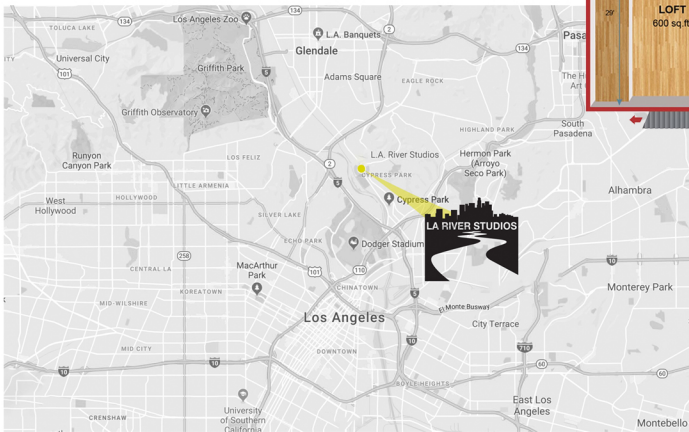
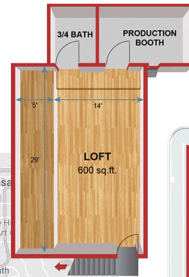

INFO@LARIVERSTUDIOS.COM | (310) 535-5510
 2800 Division Street Los Angeles CA 90065
 WWW.LARIVERSTUDIOS.COM | @LARIVERSTUDIOS